



24

COASTAL BAY

SPECIFICATIONS:

Centerline Length :	23' 10"
Beam :	8' 6"
Hull Draft :	12"- 14"
Cockpit Size :	141" x 82"
Maximum Power :	300 HP
Transom Height :	25"
Fuel Capacity :	71 Gal
Gunwale Width :	15"
Deadrise :	15"
Capacity :	OAL > 20'

STANDARD FEATURES:

- Non-Skid
- Rod Racks – Under Gunwales
- Bilge Pump, Automatic, 2,000 gph
- Fuel Tank – Alum. 0.125", Coated
- Raw Water Washdown – Optional
- Hatch Systems – Sealed
- Stainless Steel Friction Hinges
- Livewell w/ Lighting & Pumps
- Cockpit – Self Draining
- Engine Well – Self Draining
- Cored Hatches, Deck, & Liner
- Courtesy Lights
- Steering Wheel – Stainless Steel
- Fire Extinguisher
- Trim Tabs w/ Indicator
- Marine Switch Panel w/ Circuit Breakers
- Stainless Steel Pull-Up Cleats
- Bow & Transom Eyes – Stainless Steel
- Trim Tabs w/ Indicator
- Rub Rail w/ Integrated Navigation Lights
- Recessed Stainless Steel Deck Hardware
- Transom – Composite
- Toe-Rail Around Foredeck
- Foam Chambers
- Heavy Duty Resilient Perimeter Rubrail
- Stainless Steel Prop
- 10-Year Limited Structural Hull Warranty
- All Composite "No Wood"
- Console Windshield, Tinted
- Dual Battery Switch
- 12-Volt USB Port
- Console Door, Acrylic

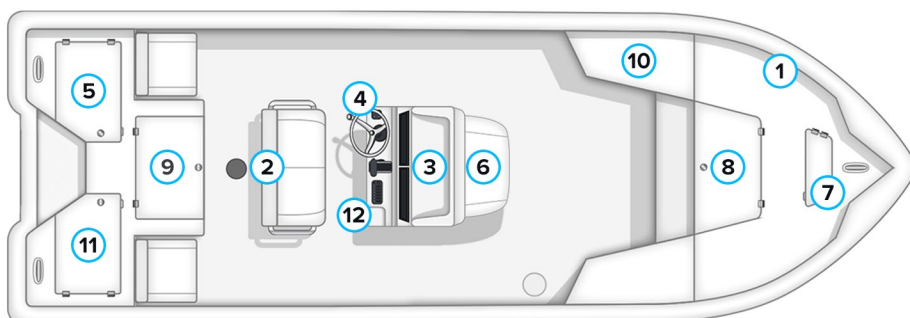

HULL STYLE

1. Modified "V" w/ exclusive Qui-Dry® Hull w/ Pocket Drive®

HELM SEATING

2. Leaning Post w/ Foot Rest, Rod Holders, Storage

CONSOLE

3. Console with Integral Forward Seat & Livewell
4. Hydraulic Steering System w/ Tilt Steering Wheel

LIVEWELLS

5. Port Aft-Deck – 42 gal Oval
6. Center Console Seat – 22 gal Oval – Optional

STORAGE

7. Bow Anchor Locker
8. Bow Dry Storage – 17 cu. ft.
9. Built-In Insulated Fish Box/Cooler – 2.5 cu. ft.
10. Built-In Forward Rod Locker – 5 cu. ft.
11. Starboard Aft-Deck Storage Area – 12.5 cu. ft.
12. Storage in Center Console